

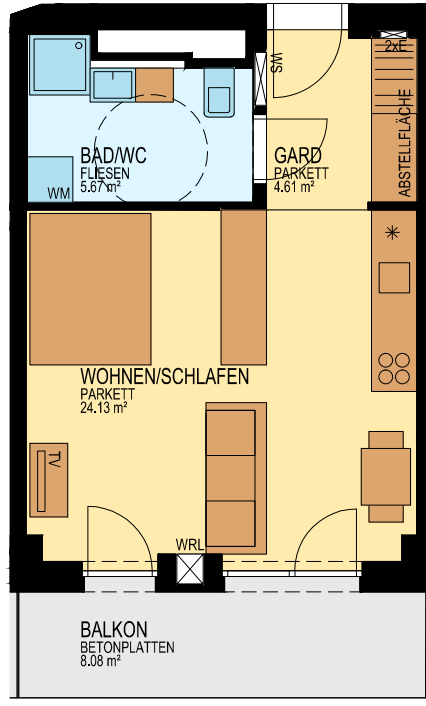

BRUCKNER TOWER

TOP 07.12

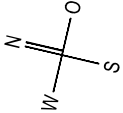

MST. 1:100

STOCKWERKSKIZZE

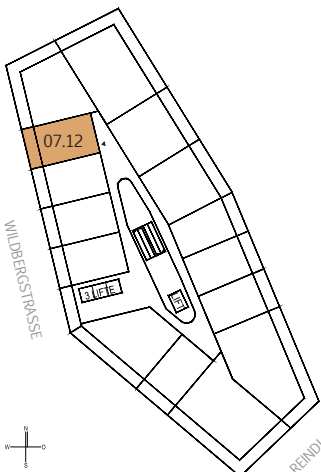

DACHTERRASSE

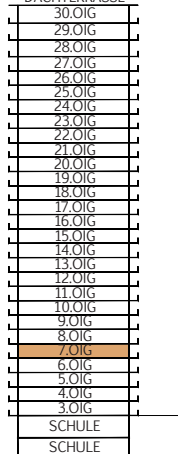

WOHNUNG	TOP 07.12
FLÄCHE:	34,41 m ²
BALKON:	8,08 m ²
GESCHOSS:	7.OIG
NIVEAU:	+20,50 m